

# SGMS Micro Air Injector

Waterway's new SGMS Micro Air Injector is designed for lower cost and ease of installation. Its low profile design is esthetically pleasing and allows the air injector to be positioned in places without a niche.

## Features:

- Micro sized
- Installs using SGMS technology
- Easy to plumb using 3/8" tubing
- Multiple body options
- LED versions optional

## Specifications:

- 1 5/16" diameter
- (44) 1/16" diameter holes
- 0.133" sq. in. total open hole area
- Uses a 43/64" diameter hole saw
- 316 stainless steel
- EPDM grommets

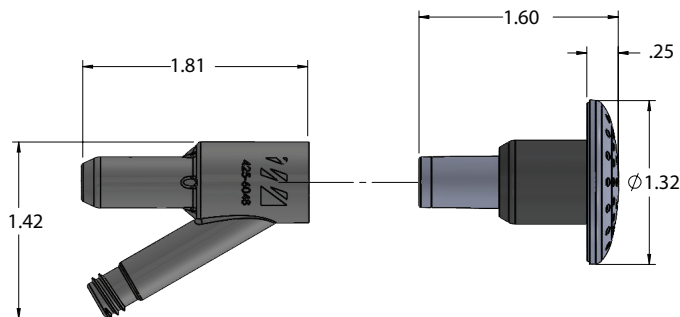
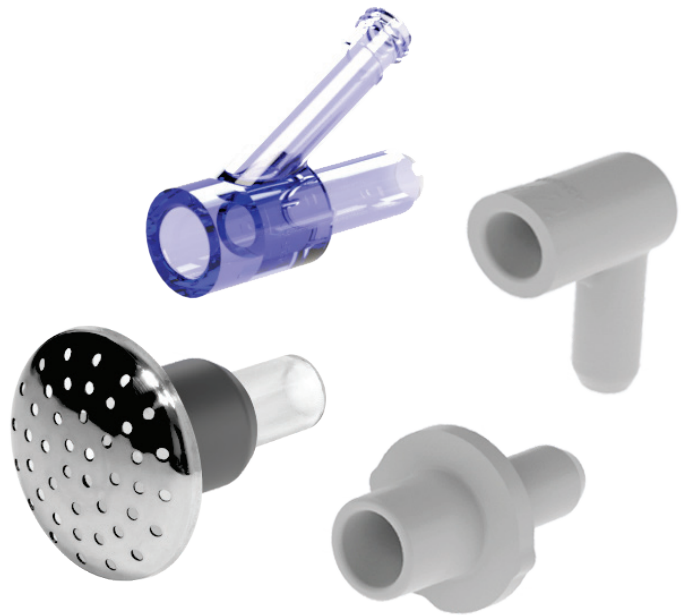

Mounting  
Made  
Easy

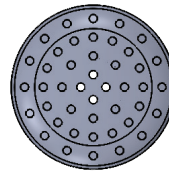

Part #	Description
670-2778S	SGMS Micro Air Injector
425-4030	3/8" SB Straight Adaptor
425-6048	1" Micro Water Feature Wye 30° LED Probe
425-6000	3/8" SB Micro 90° Ell Adaptor



Scan QR Code for more info