

### INSTALLATION INSTRUCTIONS

1. Use Three 2.7 Horsepower Variable Speed PD-270SVL.
2. Each jet can have its own designated air line with a Hartford loop. Air can also be plumbed through a manifold to control all three jets.

### SYSTEM COMPONENTS

Part No.	Description	Quantity
<b>PD-270A</b>	2.7 THP Variable Speed SVL Pump	3
<b>400-5111</b>	2.5" Union	2
<b>640-1360 V</b>	Ultra Strip Drain Diamond Style	3
<b>411-9150</b>	2.5" S Sweep Ell	14
<b>413-2320</b>	2.5" S Sanitary Tee	3
<b>660-3400</b>	Air Control A Style	1
<b>210-3920G</b>	Old Faithful Jet	3
<b>218-1570A</b>	Wrench - Old Faithful	3

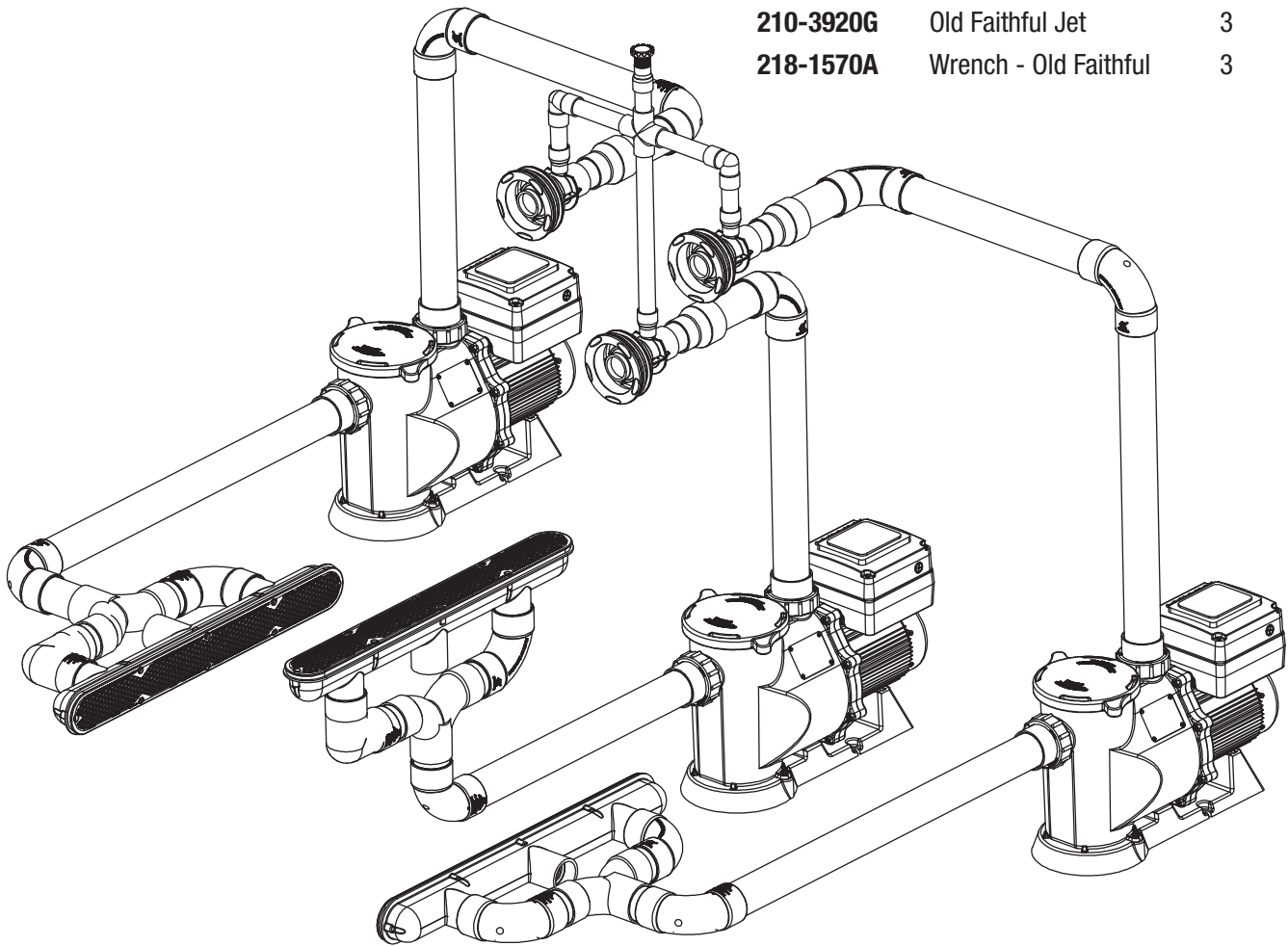

**Adapters will be needed:** Strip drains, Pump, and Tee are 2.5" Schedule 40 PVC.  
Sweeps are 3" S, Schedule 40 PVC, and each jet is 2" S, Schedule 40 PVC.

# 640-136x V Diamond Strip Drain

## Components - Concrete

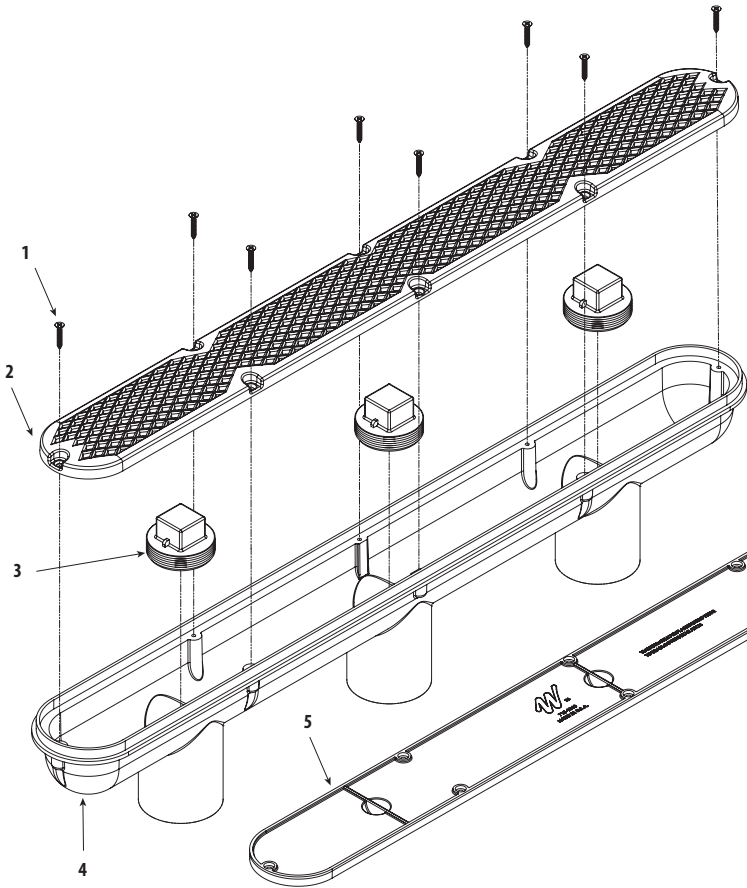

Item	Part No.	Description	Quantity
1	819-1031	3HP High Head Pump	8
2	642-134x V	32" Diamond Pattern Grate	1
3	715-9910	2" Pipe Plug	3
4	642-1320	32" 3-Port Plaster Sump	1
5	715-1360	32" Plaster Cover/Plug	1

- 

**WARNING:** The Plaster Cover/ Plug shall be removed prior to assembly of the Grate.
- 

**Hand tighten the screws using a Phillips screw driver. DO NOT use electrical or pneumatic tools for tightening the screws.**

DIAMOND STRIP DRAIN HEAD LOSS CURVE

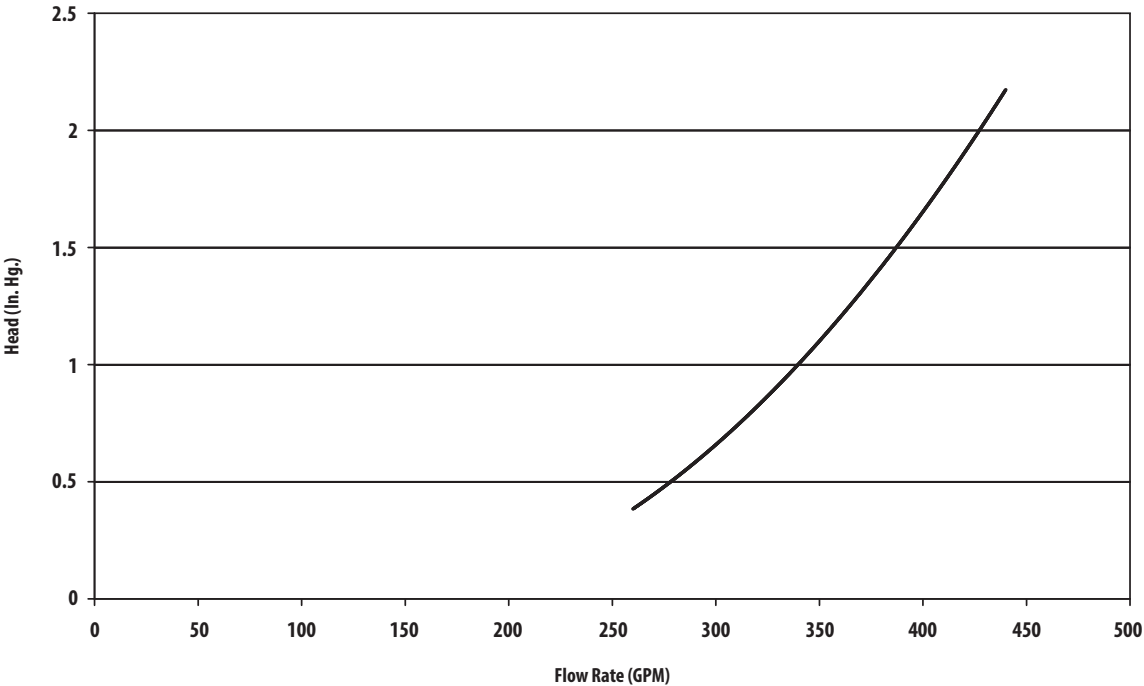

# OLD FAITHFUL STRAIGHT BODY GUNITE INSTALLATION INSTRUCTIONS

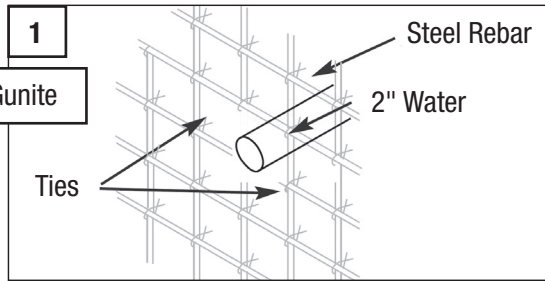

1. Position 2" pipe at the desired location for each jet.

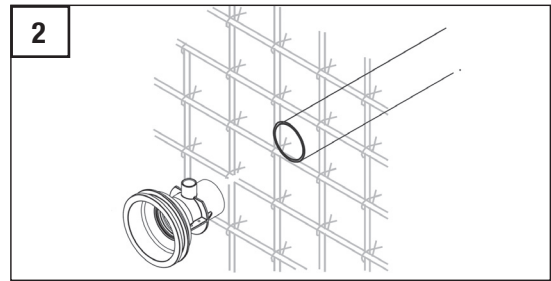

2. Estimate needed length of 2" PVC pipe by thickness of wall and length of jet body (5.87").

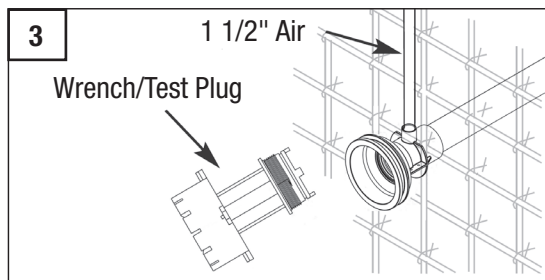

3. Glue the jet body onto the end of the pipe and 1/2" PVC for air line (3 3/4" behind face) for pressure test before guniting. Use Wrench to plug the body for pressure test.

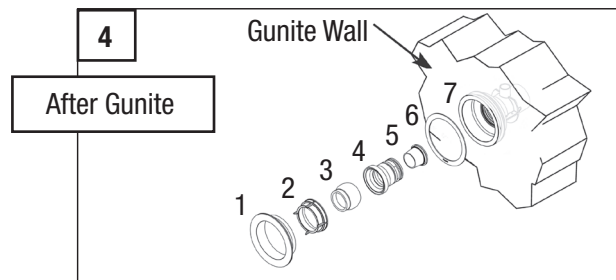

4. After guniting, install the internal components of the jet. Improper re-assembly will inhibit function of the jet.

**NOTE:** Install 0.925" nozzle in top jets, install 1.5" nozzle in bottom jet.

## SUGGESTED LAYOUT FOR 3 OLD FAITHFUL JETS

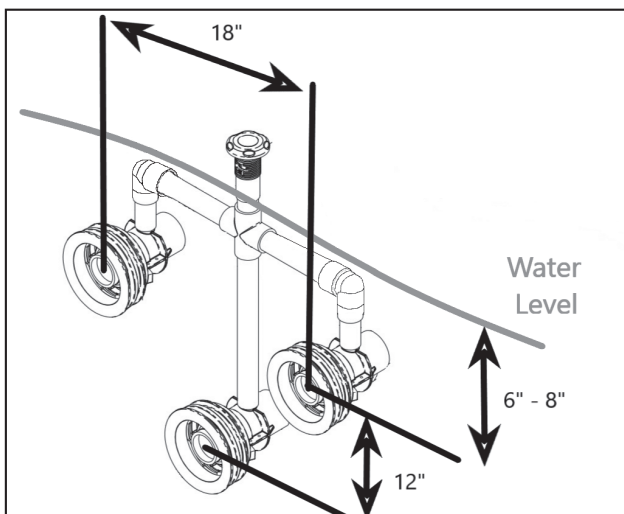

**NOTE:** Air from all three jets can be plumbed together.

## OLD FAITHFUL PART NUMBERS

Part No.	Description
1 <b>215-7340G</b>	Wall Fitting, Old Faithful
2 <b>218-7350</b>	Front Cage, Old Faithful
3 <b>213-7300</b>	Eyeball, Old Faithful
4 <b>217-7310</b>	Air Nozzle, Old Faithful
5 <b>217-7320</b>	Nozzle, Water 1.5", Old Faithful
5 <b>217-7300</b>	Nozzle, Water 0.925", Old Faithful
6 <b>711-7300</b>	Gasket, Old Faithful
7 <b>211-0150G</b>	Straight Body, Old Faithful

## OLD FAITHFUL STRAIGHT BODY DIMENSIONS

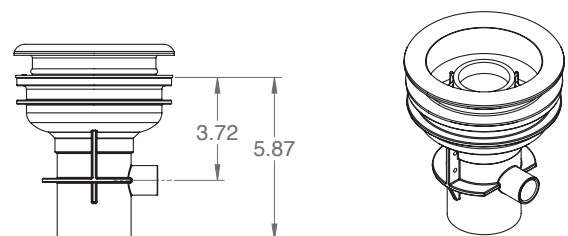

## ELECTRICAL GUIDE

MOTOR HP	VOLTS	CIRCUIT BREAKING RATING (AMPS)	BRANCH FUSETRON RATING (AMPS)	RECOMMENDED WIRE SIZE 0-50'
3	230	20	20	No. 12

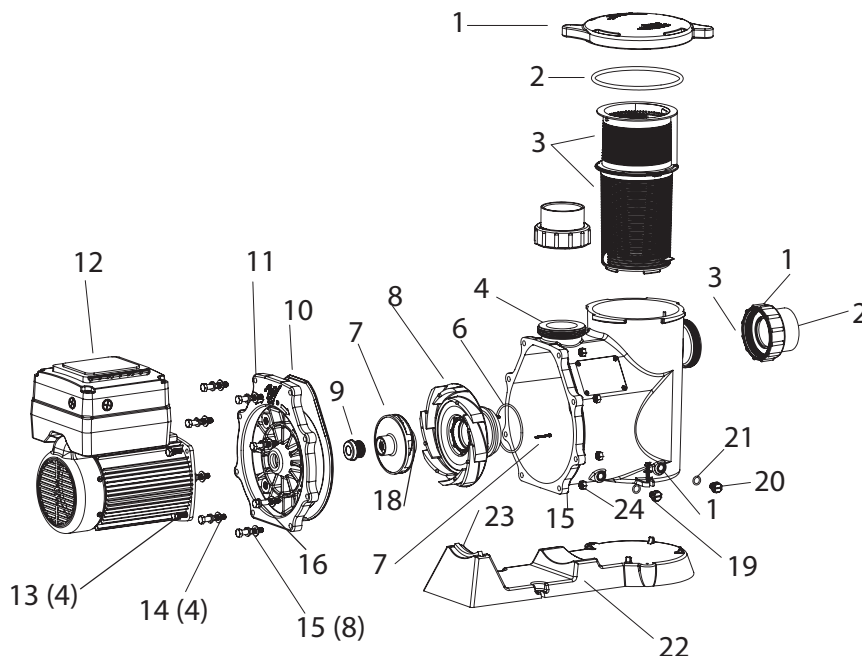

### POWER DEFENDER 270 SVL PUMP REPLACEMENT PARTS

Item	Part No.	Description	Item	Part No.	Description
1	<b>511-1310</b>	Lid	12	<b>MC-4-04</b>	PD-270 Motor
2	<b>805-0439</b>	Lid O-Ring	13	<b>819-0011</b>	Screw - 3/8" - 16 x 1/8" (4)
3	<b>319-1310</b>	Basket Assembly	14	<b>820-0017</b>	Flat Washer (12)
4	<b>315-1300</b>	Housing	15	<b>820-0016</b>	Hex Nut Ea.
5	<b>310-3300</b>	Diffuser - High-Flow	16	<b>819-4360</b>	Screw Head Left-Hand
	<b>310-7470</b>	Diffuser - High-Pressure	17	<b>711-4300</b>	SVL Gasket for Left Hand Screw
6	<b>805-0238</b>	Diffuser O-Ring	18	<b>819-0013</b>	Screw (2) Ea.
7	<b>819-0018</b>	Diffuser Screw	19	<b>820-0018</b>	Flat Washer (2) Ea.
8	<b>310-3680</b>	SVL56E-130 Impeller Assembly - High-Flow	20	<b>715-1201</b>	Drain Plug
9	<b>319-3110B</b>	Pump Seal Set - Viton	21	<b>805-0112</b>	Drain Plug O-Ring
10	<b>311-1400</b>	Faceplate	22	<b>672-1300</b>	SVL56 Base
11	<b>711-4290</b>	Faceplate Gasket	23	<b>672-1310</b>	Motor Support
			24	<b>819-0016</b>	Screw (8)

### PUMP UNION ASSEMBLY

1	<b>415-4211</b>	2 1/2" Union Nut
2	<b>417-5971</b>	2" Tailpiece
	<b>417-6001</b>	2 1/2" Tailpiece
3	<b>711-6020</b>	Gasket

### PUMP UNION REPLACEMENT PARTS

<b>400-5111</b>	2 1/2" Union x 2" Socket Tailpiece
-----------------	------------------------------------

*2 of each union are included with pump*



2200 East Sturgis Road, Oxnard CA 93030 • Phone 805.981.0262 • Fax 805.981.9403

www.waterwayplastics.com • waterway@waterwayplastics.com