

TIMER AND STAND INSTRUCTIONS

INSTALLATION INSTRUCTIONS

1. Install the timer stand (904-0021) on your accessory base (CABASE) using the plastic pins (429-7211) and bushings (429-7201) included (Figure 1).
2. Install screw (819-1260) by turning it three to four times.
3. Install the timer (904-0020) by sliding the timer's lower tab into the slot on the stand while aligning the screw head into the upper tab of the timer.
4. Open lid and tighten screw. **DO NOT OVERTIGHTEN.**

KEEP THESE INSTRUCTIONS



FIGURE 1

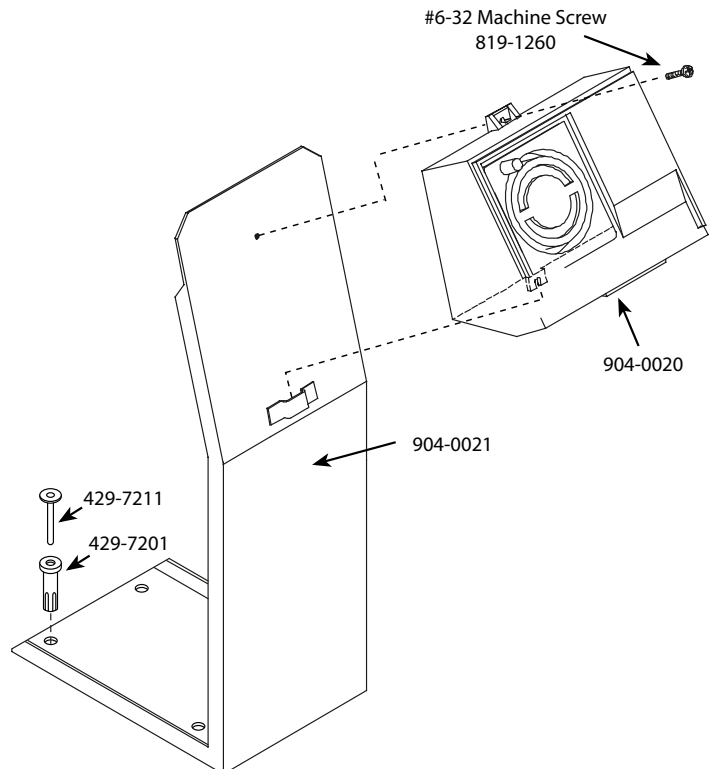

2200 East Sturgis Road, Oxnard CA 93030 • Phone 805.981.0262 • Fax 805.981.9403

www.waterwayplastics.com • waterway@waterwayplastics.com

HOW TO SET THE TIMER

1. Insert ON (blue-green) and OFF (red) trippers into dial at desired ON and OFF times (Figure 2). Be sure trippers are firmly pressed down against dial surface with at least one space between ON and OFF trippers (Figure 3).
2. Turn dial clockwise one or two revolutions until correct time of day is positioned above arrow in center of dial (Figure 4).
3. Plug pump into timer receptacle and plug timer cord into outlet. If timer is used outdoors, outlet must be suitable for wet locations.

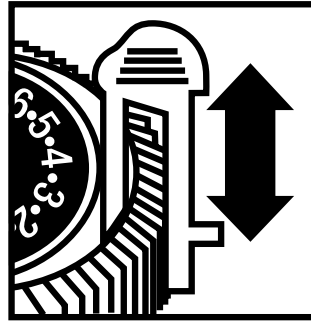

FIGURE 2

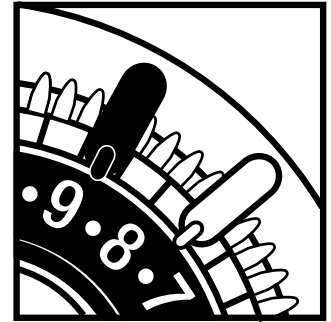

FIGURE 3

KEEP THESE INSTRUCTIONS

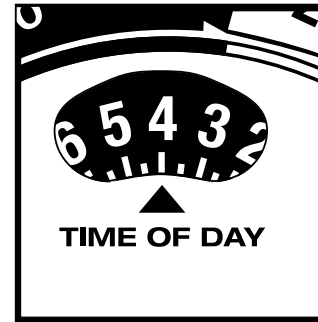
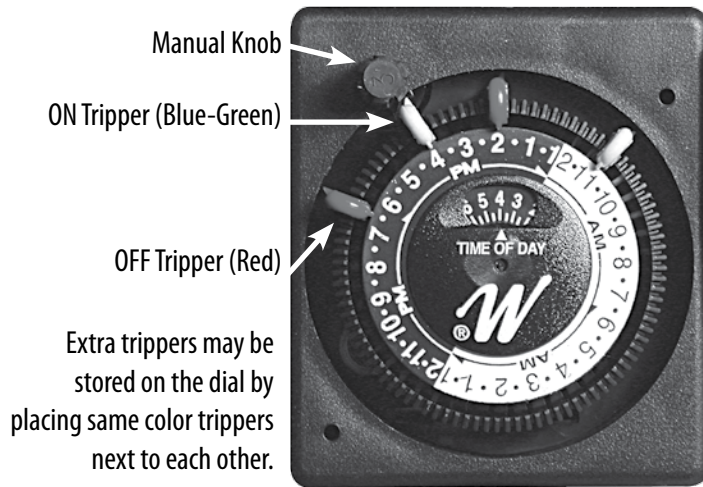

FIGURE 4

TROUBLESHOOTING GUIDE

| SYMPTOM | CAUSE(S) | CORRECTIVE ACTION |
|--|---|---|
| No power at timer's receptacle | <ul style="list-style-type: none"> • No power to timer • Timer contacts open • Defective timer | <ul style="list-style-type: none"> • Check circuit breaker in panel • Turn timer to ON, check timer settings and operation • Replace timer |
| Timer loses time | <ul style="list-style-type: none"> • Power to timer not continuous | <ul style="list-style-type: none"> • Check branch circuit that timer is plugged into |
| Timer's receptacle is hot (energized) at all times | <ul style="list-style-type: none"> • No OFF trippers in dial • Defective timer | <ul style="list-style-type: none"> • Check timer operation • Replace timer |

Timer should not be used over its rated capacity. The protective cover should always be in place.

KEEP THESE INSTRUCTIONS

WARRANTY

For product registration visit: www.waterwayplastics.com.
For Warranty questions or claims please contact point of purchase.